

RX45KFIS

Flush Mount Lift Rack

SPECIFICATIONS []

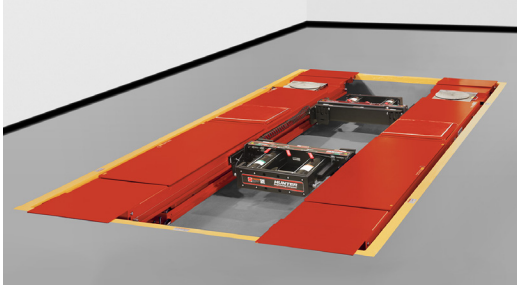

RX45KFIS (Jacks Optional)

Floor Pocket Requirements	Refer to 7507-TE-05 for details
Power Requirements	
215E	200/208/230 VAC, 1 phase, 50Hz, 26 Amp
216E	200/208/230 VAC, 1 phase, 60Hz, 26 Amp
435E	208/230/400/460 VAC, 3 phase, 50Hz, 18 Amp (208/230) / 9 Amp (400/460)
Air Supply Requirements	130 - 150 psi (9 - 10.3 bar)
Minimum Concrete Spec.	3 in. (76 mm) thick, 3000 psi (20,700 kPa) rating
Maximum Floor Slope	2 in. (51 mm) over 126 in. (3200 mm)
Max Vehicle Weight	10,000 lbs. (4500 kg)
Alignment Height	All lock positions
Min. Four-Wheel Alignment	88 in. (2235 mm)
Lifting Speed	1 speed, 55 seconds
Lowering Speed	2 speed, 25 seconds
Max. Wheelbase	
General Service	167 in. (4241 mm)
Two-Wheel Alignment	162 in. (4115 mm)
Four-Wheel Alignment	158 in. (4013 mm)

Feature	std.	opt.
6000-lb Swing Air Jacks (2)		opt.
Two-Speed Lowering	✓	
FIA Fully Integrated Alignment	✓	
POWER SLIDE	✓	
INFLATION STATION	✓	

Dimension	
Outside Width (W1)	88.5 in. (2248 mm)
Inside Width (W2)	40 in. (1016 mm)
Length (L)	215.375 in. (5471 mm)
Deck Length (DL)	200.5 in. (5093 mm)
Runway Width (R)	24 in. (610 mm)
Raised Height (H1)	72 in. (1829 mm)
Stack Height (H2)	9.25 - 10.25 in. (235 - 260 mm)

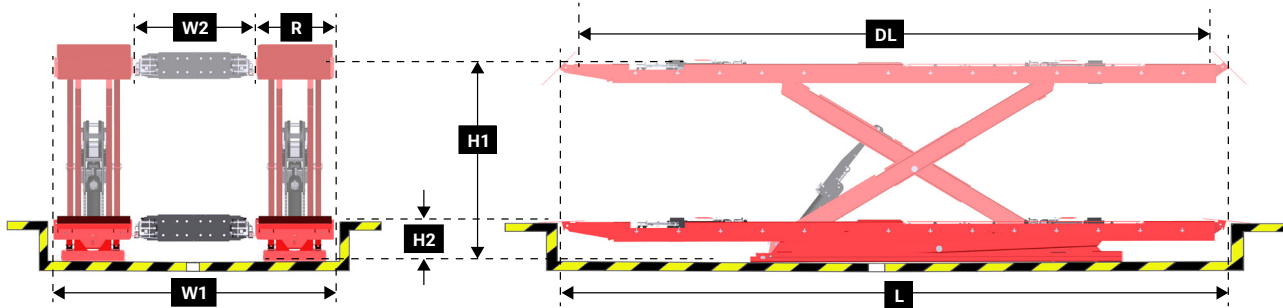

For lift rack information visit:
hunter.com/alignment-racks

For local contact visit:
hunter.com/contact

For general inquiries visit:
www.hunter.com or call 800-448-6848

RX45KFIS

Flush Mount Lift Rack

LAYOUT DIAGRAM (refer to 7507-TE-05 for construction drawings)

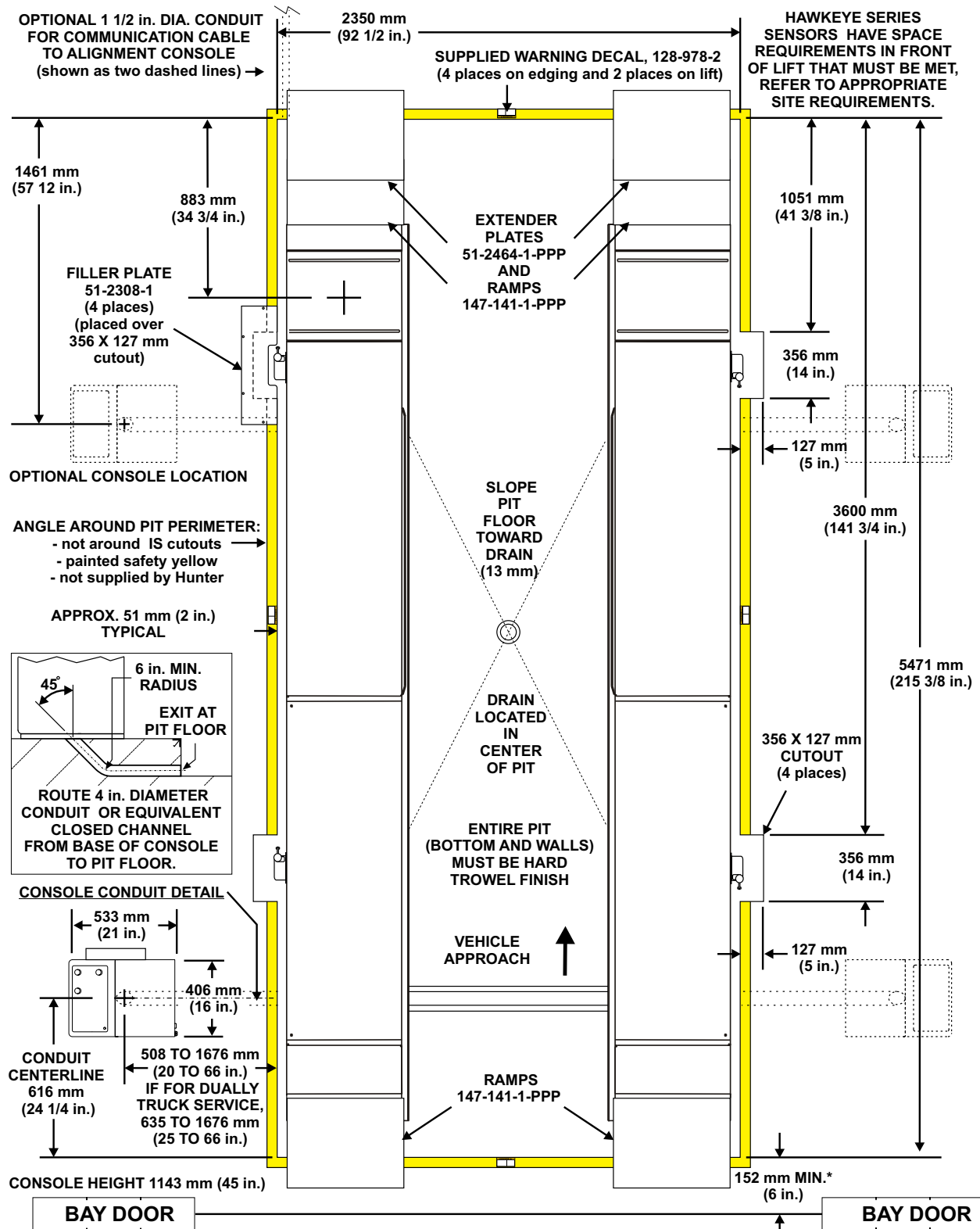

* LONGER VEHICLES WILL NEED TO BE SERVICED WITH THE BAY DOOR OPEN. TO ACCOMMODATE MOST VEHICLES, INCREASE THE SPACE BEHIND THE PIT TO 991 mm (39 in.) OR GREATER.

Dimensions shown are for end result. Tile thickness (if applicable) must be considered before pouring concrete. Positioning of control console is limited to a maximum space between console and rack of 1676 mm (66 in.) at the approach ramp end and 4877 mm (192 in.) at the turnplate end